

25	4	PHILLIPS ROUND HEAD SHEET METAL SCREW	#6 x 1/2"
24	8	DRYWALL SCREW	#6 x 1-1/4"
23	7	DRYWALL SCREW	#6 x 1-5/8"
22	2	SOCKET HEAD CAP SCREW	1/4-20NC x 1-1/2"
21	2	HEX NUT	1/4-20NC
20	4	FLAT WASHER	1/4" ID
19	4	NYLON TUBING	5/16" ID X 3/8" OD X 3"
18	4	HEX NUT	5/16-18NC
17	4	FLAT WASHER	5/16" ID
16	2	THREADED ROD	5/16-18NC x 7"
15	2	THREADED ROD	5/16-18NC x 7-1/2"
14	8	CORK STRAP PAD	3/16" x 1-1/2" x 2"
13	1	CORK CLAMP PAD	3/16" x 1" x 1-1/4"
12	1	CLAMP BLOCK	FDM PRINTED - NYLON
11	1	SWIVEL TIP, 5/16-18	MCMaster-CARR 8955A12
10	1	ALUMINUM KNOB W/5/16-18 STUD	MCMaster-CARR 60965K34
9	5	STEEL TEE NUT INSERT, 5/16-18 X 0.43"	MCMaster-CARR 90975A030
8	2	SUPPORT BLOCK - FIR/SPRUCE	"2 x 2" X 7-1/2"
7	1	REINFORCEMENT PLATE, BOTTOM STRAP, W/HOLES - OAK	1/2" x 1-1/2" x 3-1/2"
6	1	REINFORCEMENT PLATE, BOTTOM STRAP - OAK	1/2" x 1-1/2" x 3-1/2"
5	1	BOTTOM RAIL - OAK	3/4" X 1-1/2" X 9-1/2"
4	2	ARM STRAP - OAK	3/4" x 1-1/2" x 7"
3	2	ARM - OAK	3/4" x 1-1/2" x 9-1/2"
2	2	BOTTOM STRAP - OAK	3/4" x 1-1/2" x 15"
1	1	TOP STRAP - OAK	3/4" x 1-1/2" x 15"

ITEM NO.	QTY.	PART NUMBER	DESCRIPTION
DRAWN BY		DWF	DATE
			3/26/20
UNLESS OTHERWISE SPECIFIED ALL DIMENSION ARE IN INCHES.		TOLERANCES: .XX ±.01 .XXX ±.005 FRACTIONS ±1/64 ANGLES ±1°	
CONFIDENTIAL		PROJECT:	
THIS DOCUMENT IS THE CONFIDENTIAL PROPERTY OF DWF GUITARS AND IS NOT TO BE REPRODUCED, USED OR DISCLOSED BY ANYONE WITHOUT THE EXPRESS WRITTEN PERMISSION OF DWF GUITARS		TITLE: <b>NECK REMOVAL JIG</b>	
SIZE	DWG No.	REV	
C	SCALE: 2:5	SHEET: 1 of 2	

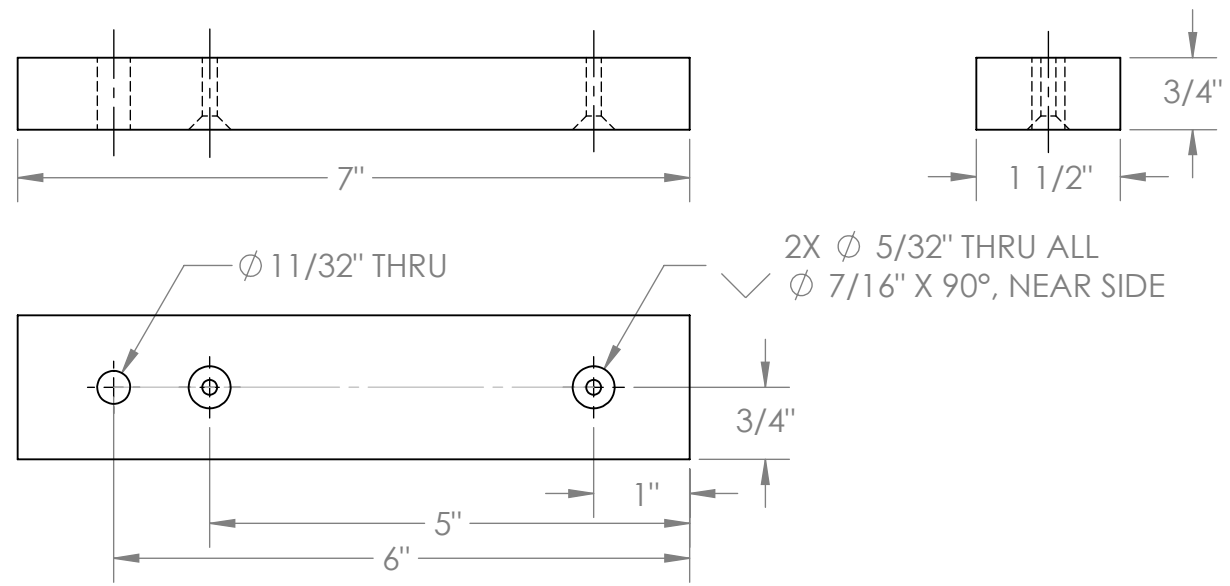

4 ARM STRAP - OAK  
(2) REQUIRED

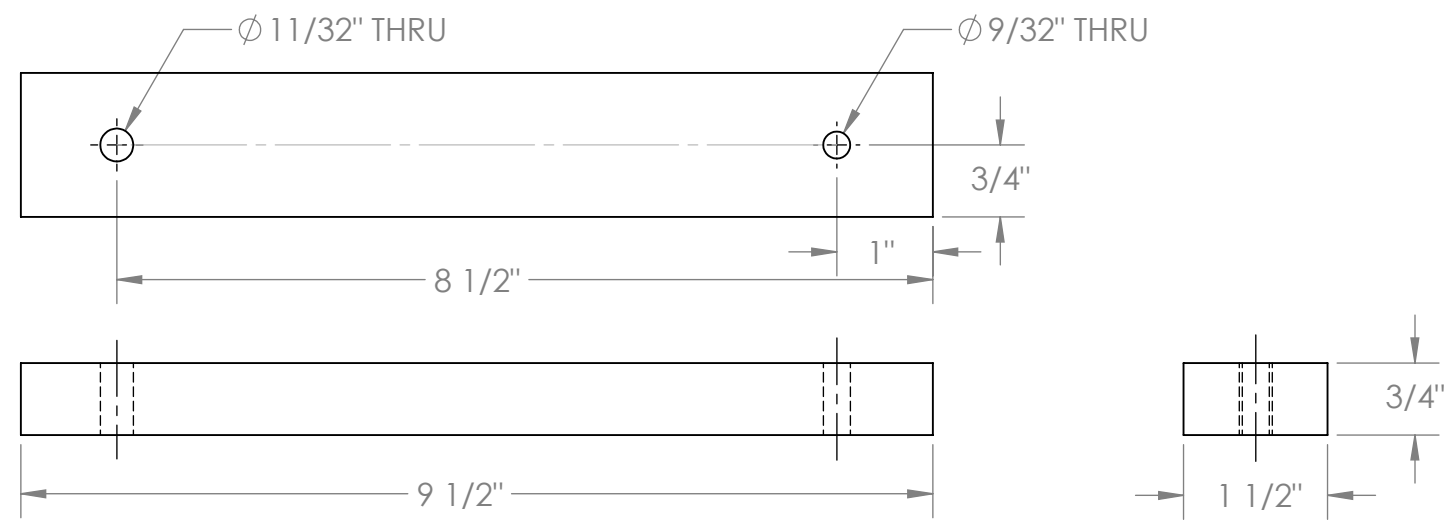

3 ARM - OAK  
(2) REQUIRED

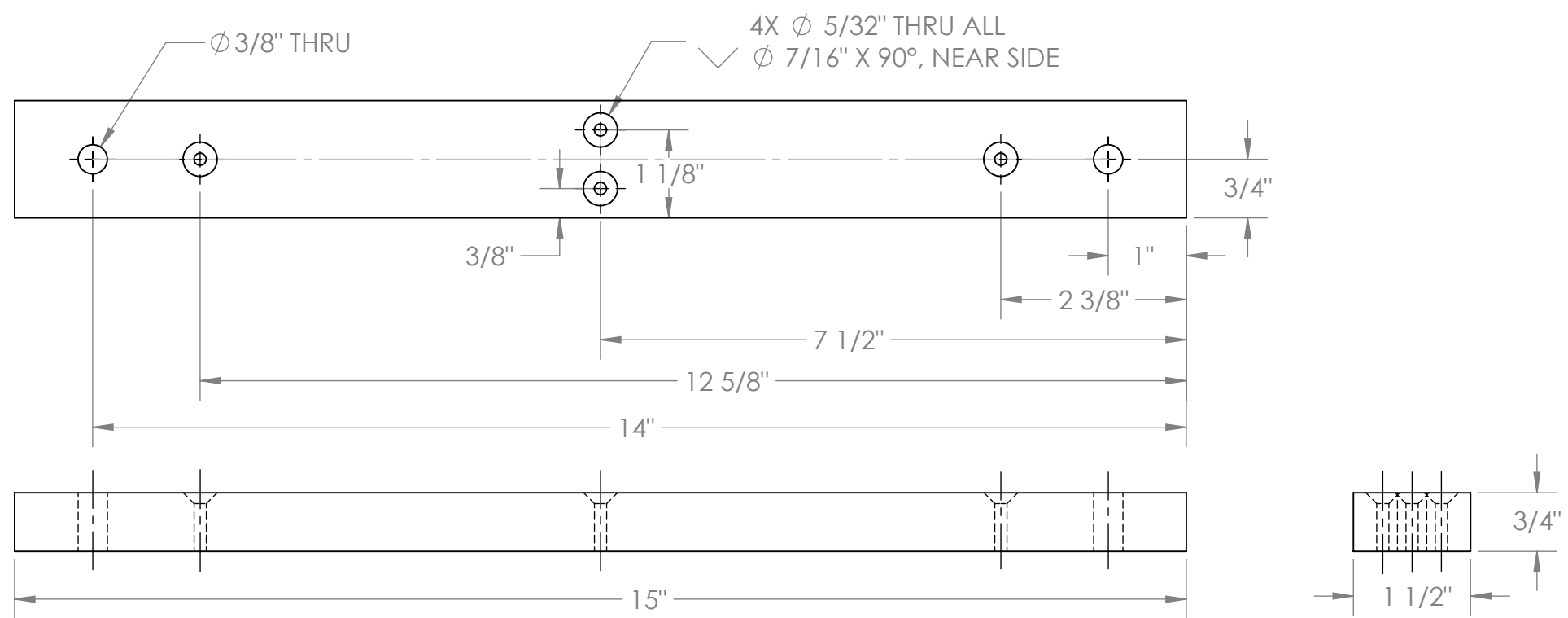

2 BOTTOM STRAP - OAK  
(2) REQUIRED

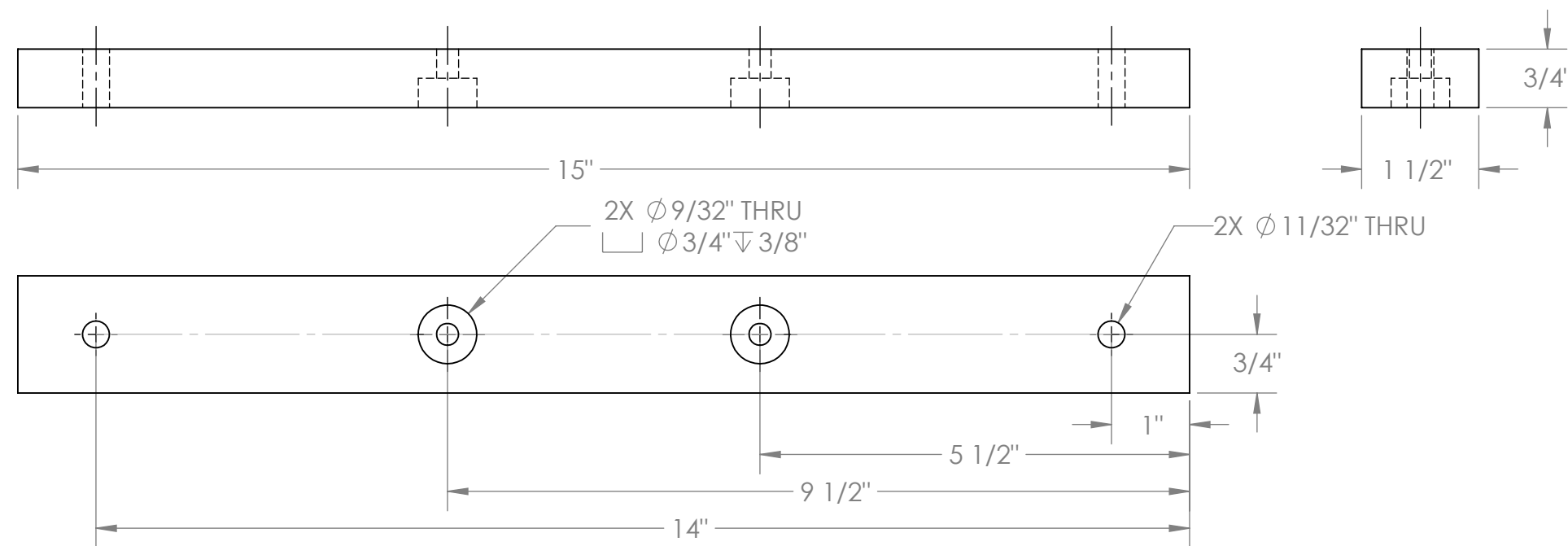

1 TOP STRAP - OAK  
(1) REQUIRED

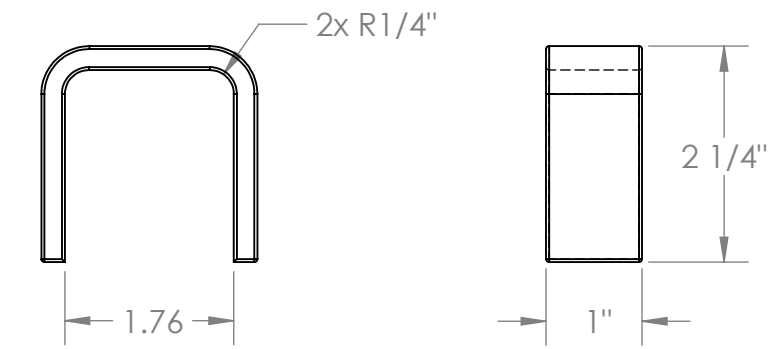

12 CLAMP BLOCK - FDM PRINTED - NYLON  
(1) REQUIRED

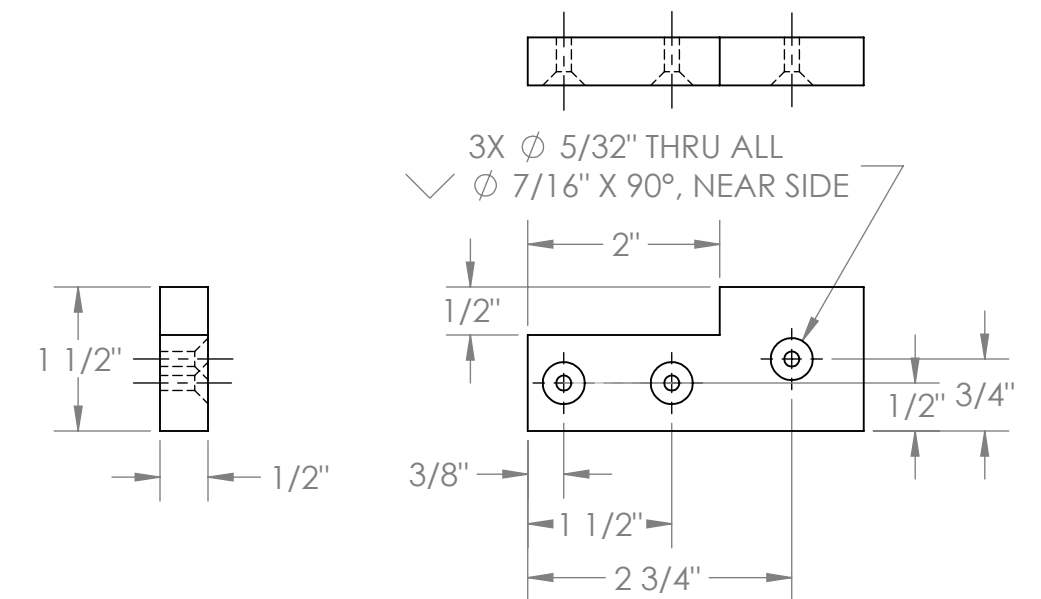

7 REINFORCEMENT PLATE, BOTTOM STRAP, W/HOLES - OAK  
(1) REQUIRED

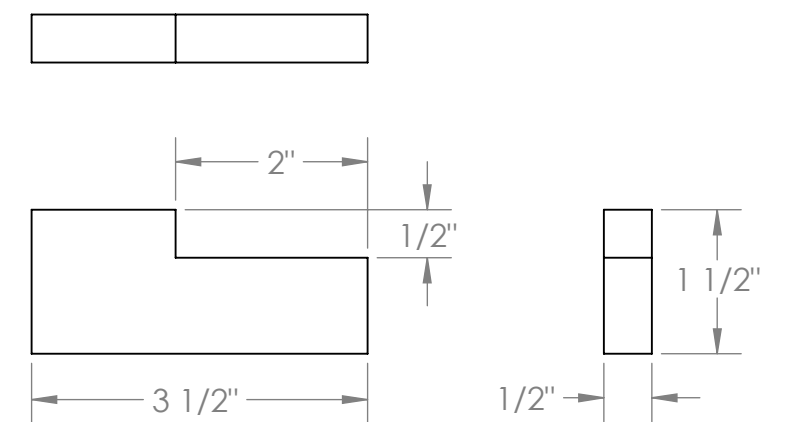

6 REINFORCEMENT PLATE, BOTTOM STRAP - OAK  
(1) REQUIRED

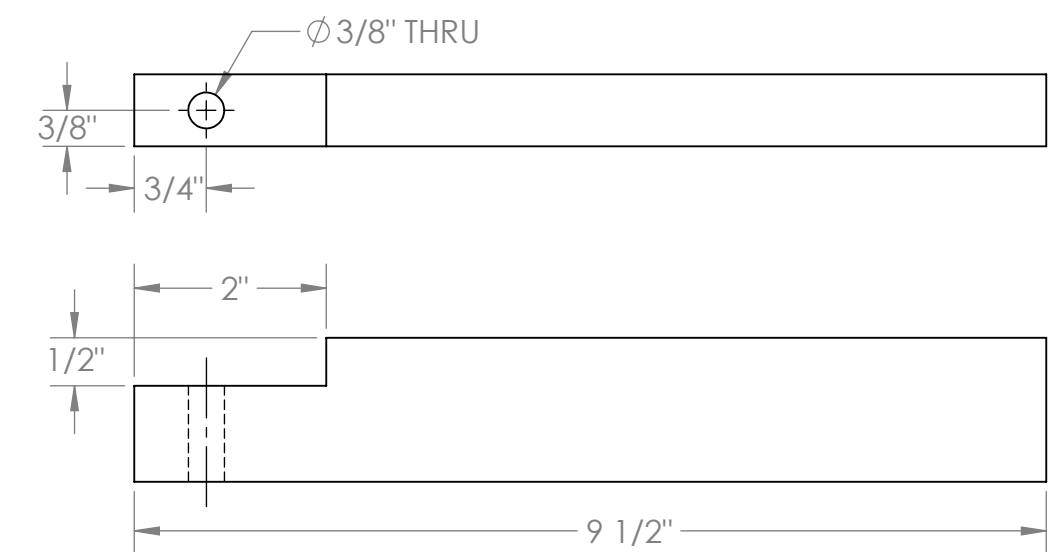

5 BOTTOM RAIL - OAK  
(1) REQUIRED

DRAWN BY <b>DWF</b>	DATE 3/26/20	<b>DWF</b> <b>DWF GUITARS</b> DWF.GUITARS@GMAIL.COM	
UNLESS OTHERWISE SPECIFIED ALL DIMENSION ARE IN INCHES.		TOLERANCES: .XX ±.01 .XXX ±.005 FRACTIONS ±1/64 ANGLES ±1°	
PROJECT:		TITLE: <b>NECK REMOVAL JIG</b>	
CONFIDENTIAL THIS DOCUMENT IS THE CONFIDENTIAL PROPERTY OF DWF GUITARS AND IS NOT TO BE REPRODUCED, USED OR DISCLOSED BY ANYONE WITHOUT THE EXPRESS WRITTEN PERMISSION OF DWF GUITARS		SIZE <b>C</b>	REV
SCALE: 1:2		SHEET: 2 of 2	